

DASH #	VOLTAGE (V)	COIL
-1	5	27Ω
-2	12	100Ω
-3	24	600Ω

REVISIONS			
REV.	DESCRIPTION	DATE	BY
A	.200±.015 WAS .190, ECN: 00149	01/27/23	P.T.
B	ADDED DASH NUMBERS FOR OTHER VOLTAGES	01/24/25	P.T.

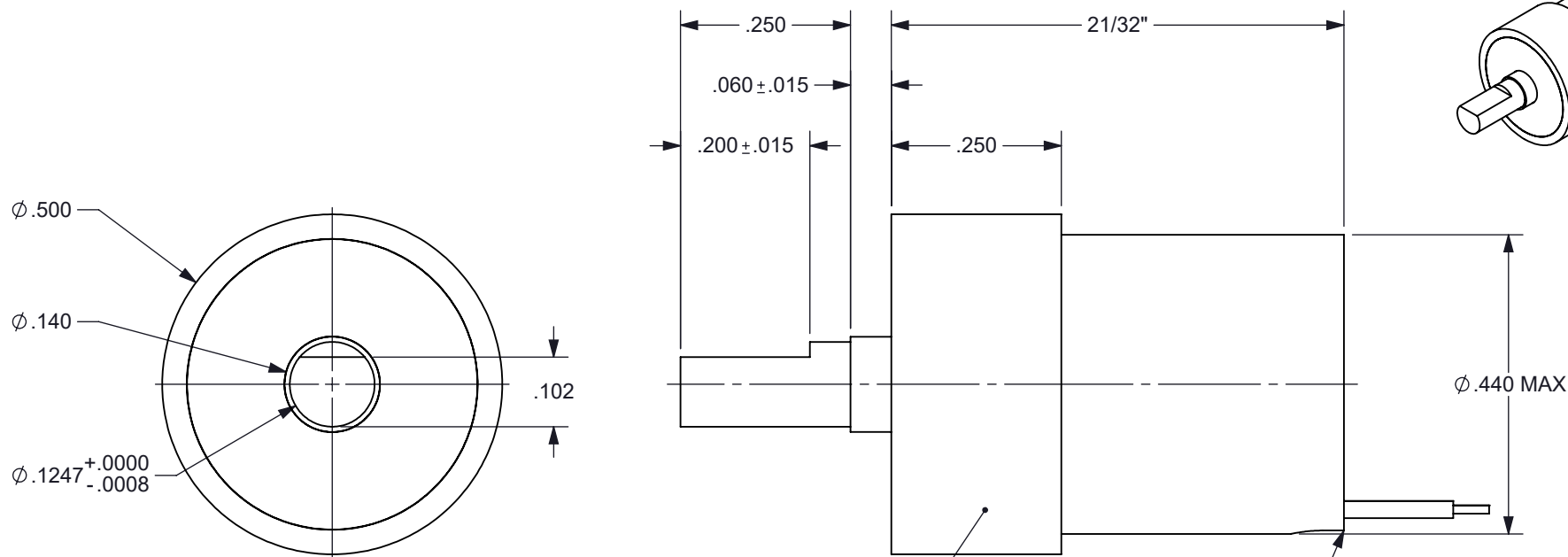

FIGURE 1

USE THIS SURFACE FOR MOUNTING

LEAD EXIT LOCATION IS
REFERENCE ONLY

SPECIFICATIONS

- | | |
|---------------------|--|
| 1. PRODUCT TYPE | SELF-RESTORING SOLENOID, LOW OUTGAS |
| 2. TEMPERATURE | -40°C TO +71°C OPERATING RANGE |
| 3. TRAVEL | 60 ± 2° (CW) FROM POSITION SHOWN IN FIGURE 1 |
| 4. ROTATION | CW / RED (+) BLACK (-) |
| 5. VOLTAGE | SEE CHART |
| 6. COIL | SEE CHART ABOVE, RESISTANCE ± 10% @ 25°C (CLASS H) |
| 7. LEADS | RED AND BLACK 30 ET TEFLON INSULATED WIRE PER M16878/6 |
| 8. LEAD LENGTH | 12" MIN, STRIPPED AND TINNED 1/8" ± 1/16" AT BOTH ENDS |
| 9. LEAD EXIT | LEAD EXIT TO BE FILLED WITH 3M 2216 B/A GRAY EPOXY |
| 10. HOUSING MARKING | LASER ENGRAVE BRANDSTROM, P/N, DATE CODE |
| 11. HOUSING FINISH | BLACK ANODIZE PER MIL-A-8625F, TYPE II, CLASS II |
| 12. MAXIMUM MASS | THE MASS OF ANY ATTACHMENT MUST BE NO MORE THAN 10 GRAMS AND BALANCED ABOUT CENTER OF ROTATION |

PROPRIETARY DOCUMENT

DIMENSION TOLERANCES UNLESS OTHERWISE SPECIFIED			
ANGLES	± 1°	2 PLACES	±.010
FRACTIONS	± 1/32	3 PLACES	±.005
	± .015	4 PLACES	±.0005
MATERIAL: SEE SPECS		DRAWN: P.T.	
FINISH: SEE SPECS		CHECKED: P.T.	
DATE: 01/21/21	SCALE: NONE	APPROVED: T.G.A.	
TITLE: SELF-RESTORING SOLENOID		DWG NO: A1439	SHEET: 1 of 1
			REV: B

**Brandstrom
Instruments**