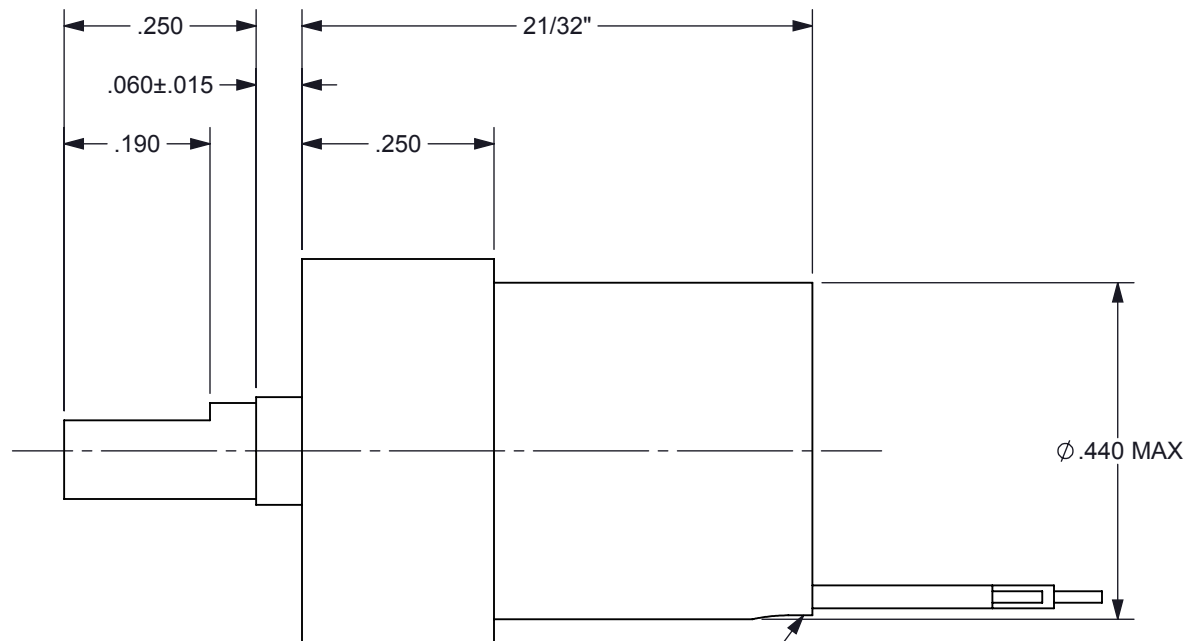
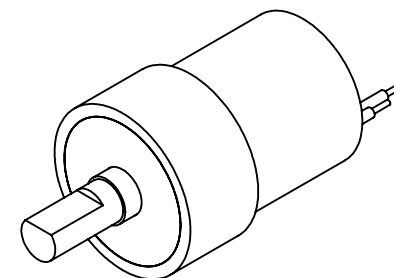

FIGURE 1



LEAD EXIT LOCATION IS REFERENCE ONLY



SPECIFICATIONS

- | | |
|---------------------|--|
| 1. PRODUCT TYPE | BI-STABLE ACTUATOR. |
| 2. TEMPERATURE | -40°C TO +71°C OPERATING RANGE |
| 3. TRAVEL | 90 ± 2° CW AS VIEWED IN FIGURE 1 |
| 4. ROTATION | CW / RED (+) BLACK (-), CCW / RED (-) BLACK (+) |
| 5. VOLTAGE | 4.3 - 5.0 VDC PULSE FOR 30 MS |
| 6. COIL | 7.3Ω ± 4% @ 25°C (CLASS H) |
| 7. LEADS | RED AND BLACK 30 ET TEFLON INSULATED WIRE PER M16878 |
| 8. LEAD LENGTH | 5.75 ± .2" LONG STRIPPED AND TINNED 1/8 ± 1/16" AT BOTH ENDS |
| 9. LEAD EXIT | LEAD EXIT TO BE FILLED WITH SILICONE ADHESIVE |
| 10. HOUSING MARKING | LASER ENGRAVED P/N, CAGE CODE, BRANDSTROM |

PROPRIETARY DOCUMENT

DIMENSION TOLERANCES UNLESS OTHERWISE SPECIFIED			
ANGLES	± 1°	2 PLACES	± .010
FRACTIONS	± 1/32	3 PLACES	± .005
	± .015	4 PLACES	± .0005
MATERIAL:	N/A		DRAWN: P.T.
FINISH:	N/A		CHECKED: R.L.R.
DATE: 11/22/13	SCALE: NONE	APPROVED: T.G.A.	
TITLE: BI-STABLE SOLENOID	DWG NO: A1193	SHEET: 1 of 1	REV:

Brandstrom Instruments