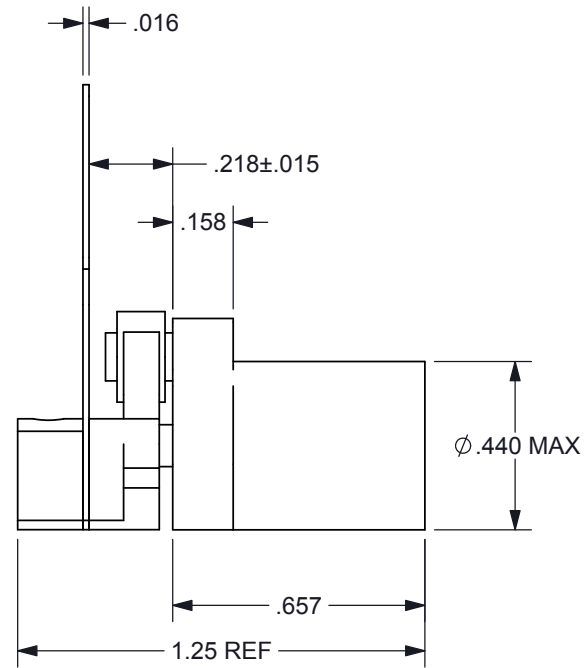

FIGURE 1



SPECIFICATIONS

1. PRODUCT TYPE	BI-STABLE SHUTTER (LOW OUTGASSING)
2. TEMPERATURE	-40°C TO +75°C OPERATING RANGE
3. TRAVEL	78 ± 2° (CW) FROM POSITION SHOWN IN FIGURE 1
4. ROTATION	CW / RED (+) BLACK (-), CCW / RED (-) BLACK (+)
5. VOLTAGE	3.3 VDC (PULSE FOR 50 MS)
6. COIL	7.3Ω ± 10% @ 25°C CLASS H
7. LEADS	RED AND BLACK 30 ET TEFLON INSULATED WIRE PER M16878/6
8. LEAD LENGTH	12"±1/4" STRIPPED AND TINNED 1/2"±1/8"
9. LEAD EXIT	LEAD EXIT TO BE FILLED WITH 3M 2216 B/A GRAY EPOXY ADHESIVE
10. HOUSING MARKING	P/N, BRANDSTROM, DATE CODE
11. HOUSING FINISH	BLACK ANODIZE PER MIL-A-8625F, TYPE II, CLASS II
12. SHUTTER FINISH	BLACK ANODIZE PER MIL-A-8625F, TYPE II, CLASS II

PROPRIETARY DOCUMENT

DIMENSION TOLERANCES UNLESS OTHERWISE SPECIFIED ANGLES ± 1° 2 PLACES ± .010 FRACTIONS ± 1/32 3 PLACES ± .005 1 PLACE ± .015 4 PLACES ± .0005				
MATERIAL: SEE SPECIFICATIONS				DRAWN: B.K.
FINISH: SEE SPECIFICATIONS		CHECKED: P.T.		
DATE: 03/23/16	SCALE: NONE	APPROVED: T.G.A.		
TITLE: BI-STABLE SHUTTER		DWG NO: A1267	SHEET: 1 of 1	REV: