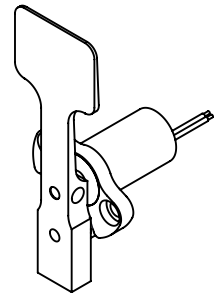
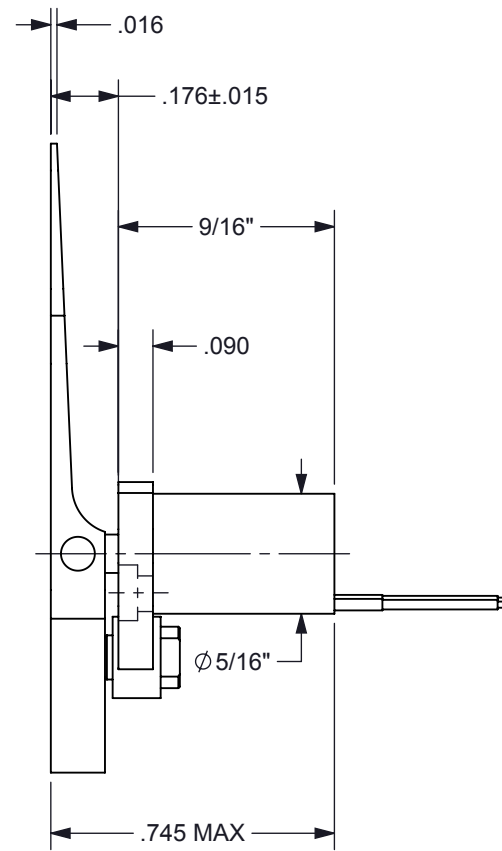

FIGURE 1



**SPECIFICATIONS**

- |                    |  |
|--------------------|--|
| 1. PRODUCT TYPE    | BI-STABLE SOLENOID   |
| 2. TEMPERATURE     | -40°C TO +65°C OPERATING RANGE   |
| 3. TRAVEL          | 48° ± 4° FROM POSITION SHOWN IN FIGURE 1                                   |
| 4. ROTATION        | CW / RED (+) BLACK (-), CCW / RED (-) BLACK (+)                            |
| 5. VOLTAGE         | 3.3 VDC  |
| 6. COIL            | 27Ω ± 5% @ 25°C (CLASS H)  |
| 7. LEADS           | RED AND BLACK 30 ET TEFLON INSULATED WIRE PER M16878/6                     |
| 8. LEAD LENGTH     | 2 1/8 ± 1/8"   |
| 9. HOUSING MARKING | LASER ENGRAVE BI, P/N, DATE CODE   |
| 10. HOUSING FINISH | ANODIZE PER MIL-A-8625F, TYPE II, CLASS II<br>BLACK #37038 PER FED-STD-595 |
| 11. STOP MATERIAL  | PROPRIETARY COMPLIANT STOP   |

**PROPRIETARY DOCUMENT**

DIMENSION TOLERANCES UNLESS OTHERWISE SPECIFIED			
ANGLES	± 1°	2 PLACES	± .010
FRACTIONS	± 1/32	3 PLACES	± .005
	± .015	4 PLACES	± .0005
MATERIAL:	SEE SPECS	DRAWN:	PT
FINISH:	SEE SPECS	CHECKED:	P.J.T.
DATE:	2/12/16	SCALE:	NONE
APPROVED:	T.G.A.		
TITLE:	BI-STABLE SOLENOID	DWG NO:	A1262
		SHEET:	1 of 2
		REV:	

**Brandstrom  
Instruments**