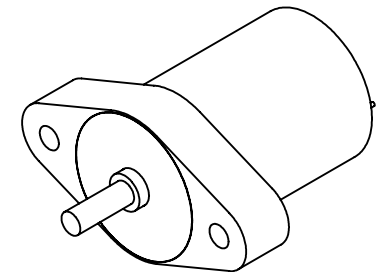
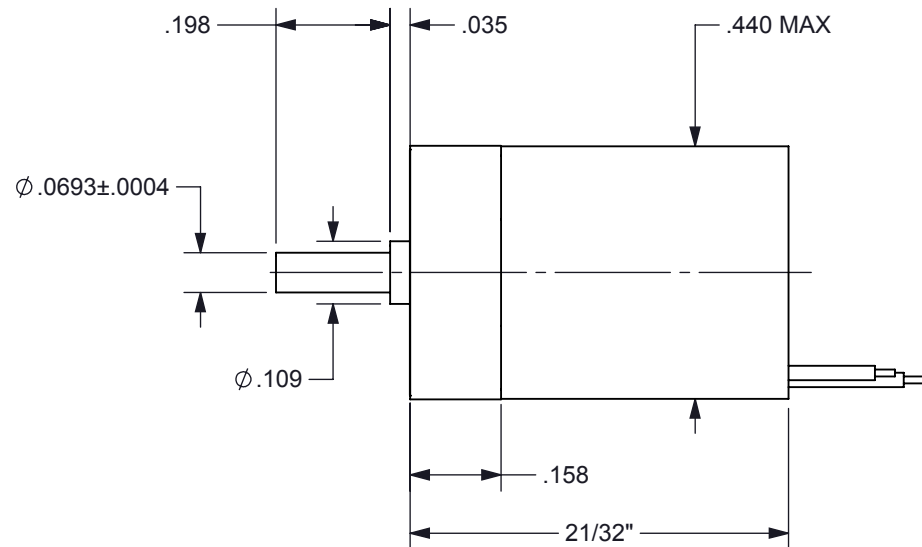

FIGURE 1



PROPRIETARY DOCUMENT

SPECIFICATIONS

1. PRODUCT TYPE	BI-STABLE SOLENOID
2. TEMPERATURE	-35°C TO +60°C OPERATING RANGE
3. TRAVEL	57 ± 2° CW FROM POSITION SHOWN IN FIGURE 1
4. ROTATION	CW / RED (+) BLACK (-), CCW / RED (-) BLACK (+)
5. VOLTAGE	3 ± 0.3 VDC (PULSE FOR 100 MS)
6. COIL	7.3Ω ± 4% @ 25°C (CLASS H)
7. LEADS	RED AND BLACK 30 ET TEFLON INSULATED WIRE PER M16878/6
8. LEAD LENGTH	3.0 ± 0.1" STRIPPED 1/4" ± 1/8" AT BOTH ENDS
9. HOUSING FINISH	BLACK ANODIZE PER MIL-A-8625F, TYPE II, CLASS II

DIMENSION TOLERANCES UNLESS OTHERWISE SPECIFIED ANGLES ± 1° 2 PLACES ± .010 FRACTIONS ± 1/32 3 PLACES ± .005 1 PLACE ± .015 4 PLACES ± .0005			
MATERIAL: SEE SPECS		DRAWN: C.N.M.	
FINISH: SEE SPECS		CHECKED: P.T.	
DATE: 9/25/2014	SCALE: NONE	APPROVED: R.L.R.	
TITLE: BI-STABLE SOLENOID		DWG NO: A1096-1	SHEET: 1 of 1