

ROTATION DIRECTION FROM THIS VIEW

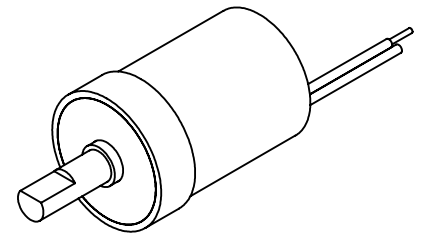
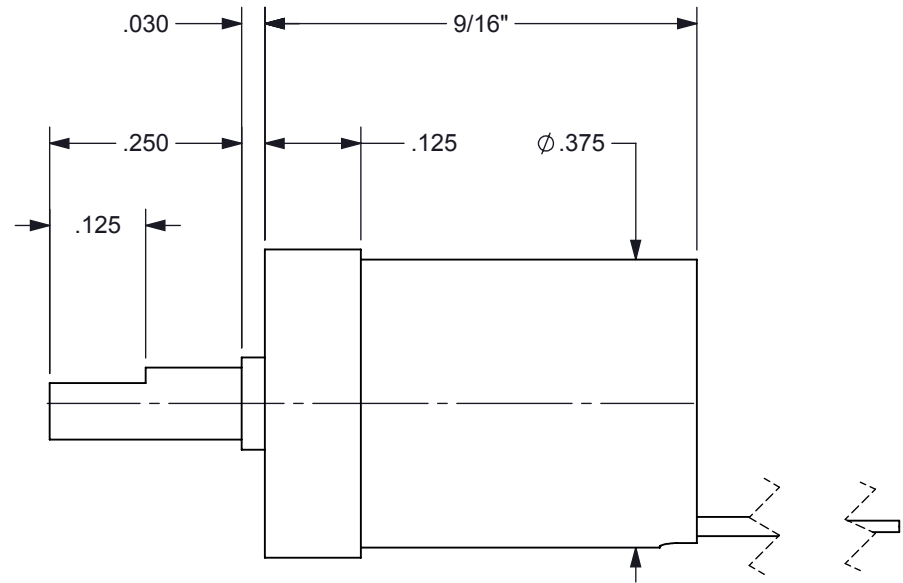

**PROPRIETARY DOCUMENT**

**SPECIFICATIONS**

1. PRODUCT TYPE	BI-STABLE SOLENOID
2. TEMPERATURE	-40°C TO +65°C OPERATING RANGE
3. TRAVEL	45° ± 2°
4. ROTATION	CW/RED(+) BLACK(-), CCW/RED(-) BLACK (+)
5. VOLTAGE	5VDC PULSE FOR 50-100 MS
6. COIL	30Ω ± 5% @ 25°C (CLASS H)
7. LEADS	RED AND BLACK 30 ET TEFLON INSULATED WIRE PER M16878/6
8. LEAD LENGTH	6" ± 1/4" STRIPPED AND TINNED 1/8" ± 1/16"
9. HOUSING MARKING	LASER ENGRAVE PART NUMBER, DATE CODE, BRANDSTROM
10. HOUSING FINISH	ANODIZE PER MIL-A-8625F, TYPE II, CLASS II BLACK #37038 PER FED-STD-595

DIMENSION TOLERANCES UNLESS OTHERWISE SPECIFIED ANGLES ± 1° 2 PLACES ± .010 FRACTIONS ± 1/32 3 PLACES ± .005 1 PLACE ± .015 4 PLACES ± .0005			
MATERIAL: SEE SPECS		DRAWN: P.T.	
FINISH: SEE SPECS		CHECKED: C.N.M.	
DATE: 4/17/14	SCALE: NONE	APPROVED: T.G.A.	
TITLE: BI-STABLE SOLENOID		DWG NO: A1214	SHEET: 1 of 1

**Brandstrom  
Instruments**